

# Access

## Nearest Station (Senri-chuo)

- From Kansai Airport (KIX)
  - Airport Limousine Bus  
KIX → Hotarugaike
  - Osaka Monorail  
Hotarugaike → Senri Chuo
  
- From Osaka Airport (ITM)
  - Osaka Monorail  
Osaka-airport → Senri Chuo
  
- From Shin-osaka Shinkansen Station
  - Osaka Metro Midosuji Line  
Shin-osaka → Senri-chuo

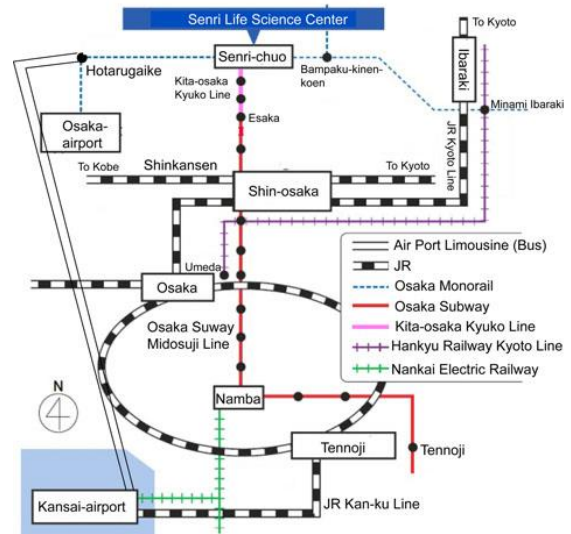

## Senri Life Science Center

From "Senri-chuo" subway station

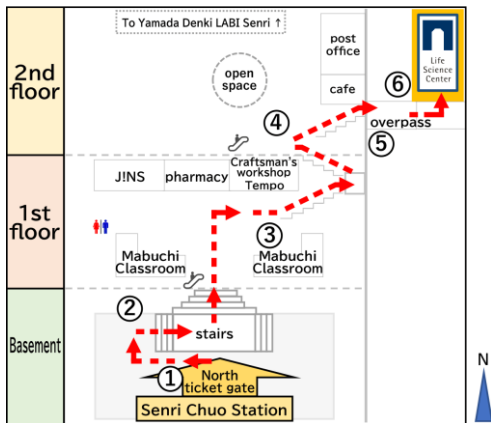

From Osaka Monorail "Senri Chuo" station

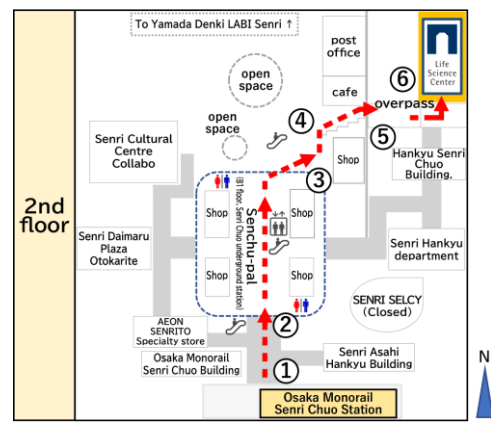

**Entrance** There is a convenience store and a coffee shop in the entrance floor (1F).

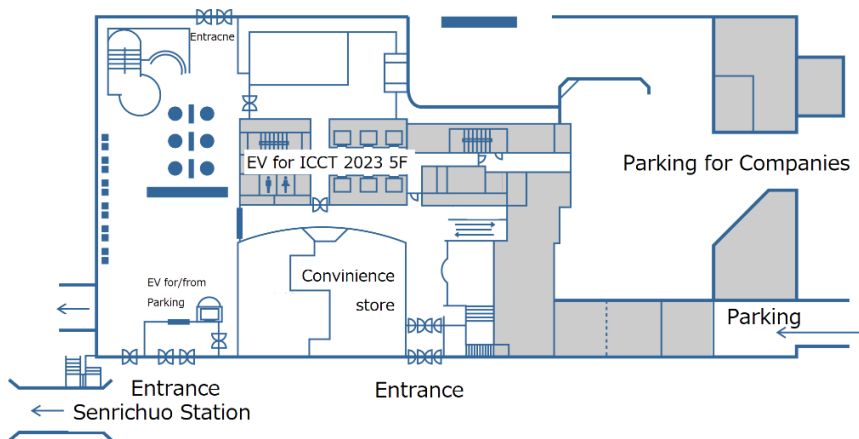

# Room Guide

## 5<sup>th</sup> Floor

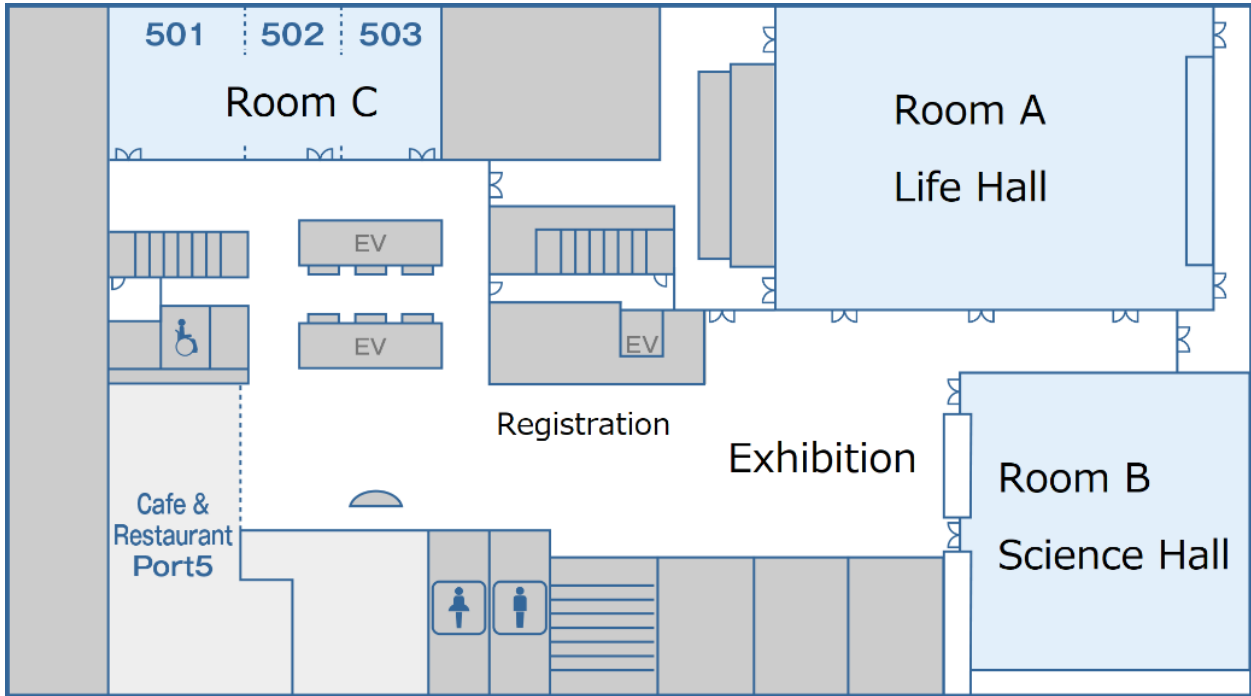

## 6<sup>th</sup> Floor

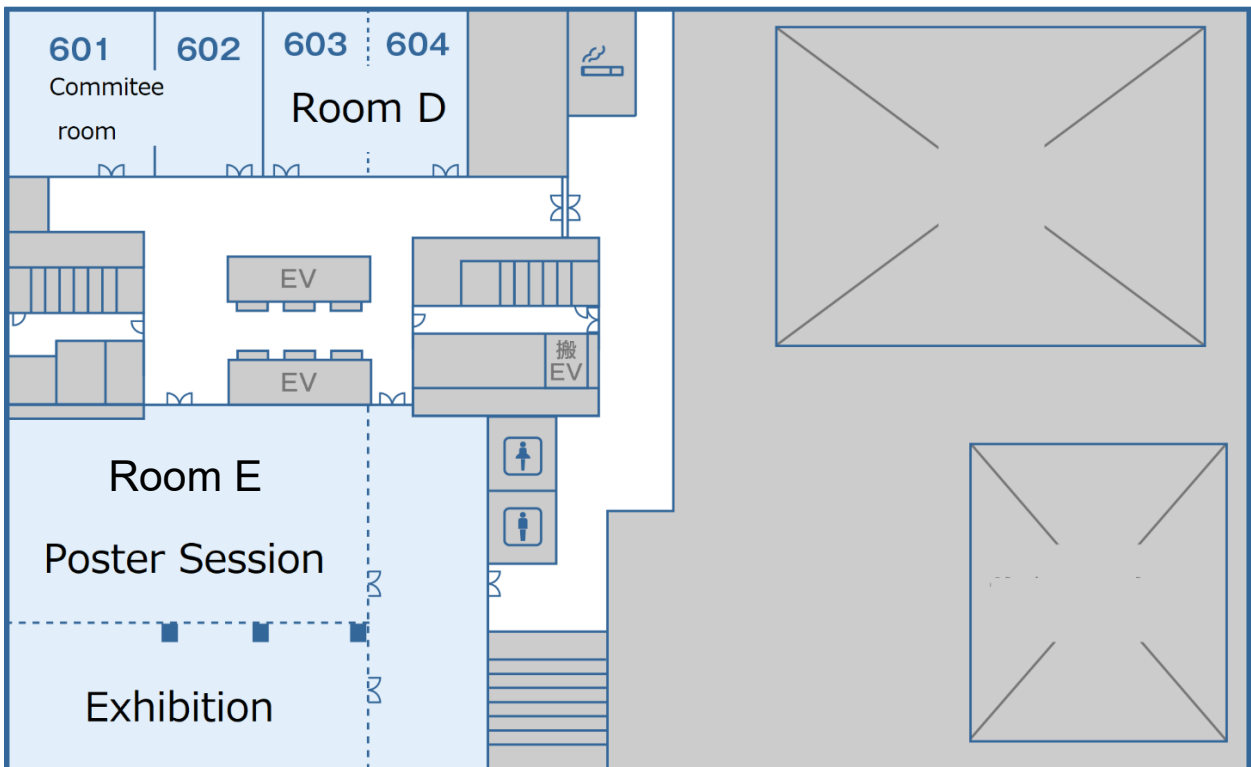

## Room Assignment

### Plenary Session

- Plenary Lectures Room A
- Rossini Award Lecture Room A

### Parallel Session

1. Fluid & Phase Equilibria Room A
2. Colloids & Interfaces Room B
3. Bio-materials (Foods & Pharmaceuticals) Room C
4. Bio-thermodynamics Room C
5. Polymers & Organic Materials Room B
6. Inorganic Materials & Metals Room A
7. Condensed Matter: Physical Science & Applications Room D
8. Instrumental & New Techniques Room C
9. Database & Industrial Applications Room B
10. Environmental & Safety Room C, D

### Poster Session

- PS-I (July 31) Room E
- PS-II (August 3) Room E

### Exhibition

- Quantum Design Japan (attocube, interference) Lobby / Room E
- TA Instruments JAPAN Lobby / Room E
- Nihon Thermal Consulting Co. Lobby / Room E
- NETZSCH Japan Lobby / Room E
- Malvern Panalytical a spectris company Lobby / Room E
- Thermal Block Company Lobby / Room E
- ScienceEdge Inc. Lobby / Room E

### Events

- Welcome Reception Room E
- Opening / Closing Room A
- Young Scientists' Session (August 1) Room B
- Special Lecture (August 2) Room C
- BIRA seminar (August 2) Room B
- IACT Business Meeting Room A
- Sponsor Session (August 2) Room A